

'Classical' Pulleys

1/5" (XL) pitch

Moulded with imperial insert

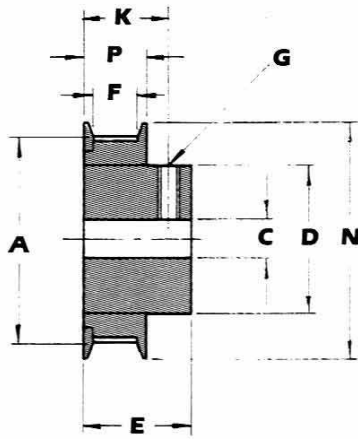

type A

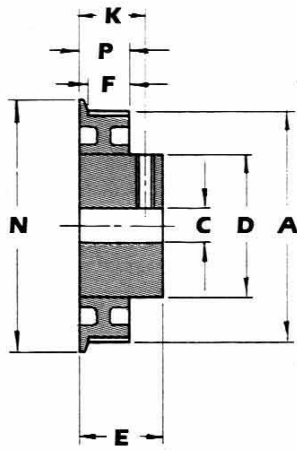

type B

All dimensions in inches

Material

Hub	Aluminium Alloy BS4300/5:1973FCI
Pulley	Nylon : Zytel 73 G25 PA6 25% Glass filled

Bore tolerance to BS. 1916: 1953

Pt. 1(H9)

General tolerance unless otherwise stated $\pm 0.010''$

Tooth dimensions to BS4548: 1970
Working temperature range -40°C to $+80^{\circ}\text{C}$

All pulleys supplied with grubscrews.

Please state catalogue number of required pulley when ordering.

No. Teeth	Type	Pitch dia	Outside dia A	Bore dia C	Boss dia D	Overall length E	Face-width F	G	K	Flange dia N	P	Catalogue No.
10	A	0.637	0.617	0.125	0.438	0.826	0.406	1xM3	0.675	0.867	0.531	P10XL037
12	A	0.764	0.744	0.125	0.438	0.826	0.406	1xM3	0.675	0.994	0.531	P12XL037
14	A	0.891	0.871	0.125	0.438	0.826	0.406	1xM3	0.675	1.121	0.531	P14XL037
15	A	0.955	0.935	0.187	0.688	0.826	0.406	1xM4	0.675	1.185	0.531	P15XL037
16	A	1.018	0.999	0.187	0.688	0.826	0.406	1xM4	0.675	1.249	0.531	P16XL037
18	A	1.146	1.126	0.250	0.812	0.826	0.406	2xM4	0.675	1.376	0.531	P18XL037
20	A	1.273	1.253	0.250	0.812	0.826	0.406	2xM4	0.675	1.503	0.531	P20XL037
21	A	1.337	1.317	0.250	1.218	0.906	0.406	2xM5	0.718	1.563	0.531	P21XL037
22	A	1.400	1.381	0.250	0.875	0.906	0.406	2xM5	0.718	1.631	0.531	P22XL037
24	A	1.528	1.508	0.250	1.000	0.906	0.406	2xM5	0.718	1.758	0.531	P24XL037
26	A	1.655	1.635	0.250	1.000	0.906	0.438	2xM5	0.718	1.875	0.563	P26XL037
28	A	1.783	1.763	0.250	1.000	0.906	0.438	2xM5	0.718	2.013	0.563	P28XL037
30	A	1.910	1.890	0.375	1.563	0.937	0.438	2xM5	0.718	2.140	0.563	P30XL037
32	B	2.037	2.019	0.250	1.000	0.906	0.500	2xM5	0.718	2.268	0.563	P32XL037
36	B	2.292	2.272	0.375	1.563	0.938	0.500	2xM5	0.750	2.522	0.563	P36XL037
40	B	2.546	2.526	0.375	1.563	0.938	0.500	2xM5	0.750	2.776	0.563	P40XL037
42	B	2.674	2.654	0.375	1.563	0.938	0.500	2xM5	0.750	2.903	0.563	P42XL037
44	B	2.801	2.781	0.375	1.563	0.938	0.500	2xM5	0.750	3.030	0.563	P44XL037
48	B	3.056	3.036	0.375	1.563	0.938	0.500	2xM5	0.750	3.286	0.563	P48XL037
60	B	3.820	3.800	0.375	1.563	0.938	0.500	2xM5	0.750	4.050	0.563	P60XL037
72	B	4.584	4.564	0.375	1.563	0.938	0.500	2xM5	0.750	4.814	0.563	P72XL037