

# Whitney Dovetail Milling Cutters

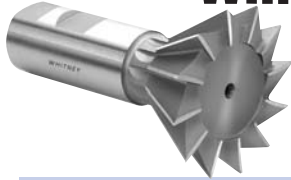

## ► HIGH SPEED STEEL/H.S.S. TiN COATED

- Right Hand Cut
- Single Angle
- Straight Shank

### Tolerances:

Dia. +/- .010  
Angle: +/- (1/4°)

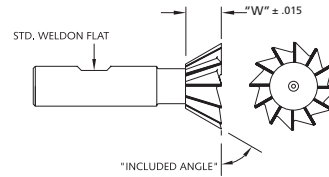

## Straight Tooth

Shaded areas are NEW to this year's catalog

| H.S.S. WTC No. | H.S.S. EDP No. | H.S.S. Price | Cutter Dia. | Included Angle | Cutter Width | Shank Dia. | Overall Length | No. of Teeth | TiN Coat WTC No. | TiN Coat EDP No. | TiN Coat Price |       |       |
|----------------|----------------|--------------|-------------|----------------|--------------|------------|----------------|--------------|------------------|------------------|----------------|-------|-------|
| 901245         | 10597          | \$32.00      | 1/8"        | 45°            | .040"        | 1/4"       | 2"             | 4            | 901245T          | 15597            | \$36.00        |       |       |
| 901845         | 10599          | 32.00        | 3/16"       |                | 4            |            |                | 901845T      | 15599            | 36.00            |                |       |       |
| 902545         | 10600          | 32.00        | 1/4"        |                | 6            |            |                | 902545T      | 15600            | 36.00            |                |       |       |
| 903745         | 10260          | 37.35        | 3/8"        |                | 6            |            |                | 903745T      | 15260            | 41.00            |                |       |       |
| 905045         | 10261          | 37.35        | 1/2"        |                | 8            | 905045T    | 15261          | 42.50        |                  |                  |                |       |       |
| 907545         | 10262          | 37.35        | 3/4"        |                | 8            | 907545T    | 15262          | 45.75        |                  |                  |                |       |       |
| 910045         | 10263          | 43.35        | 1"          |                | 10           | 910045T    | 15263          | 55.25        |                  |                  |                |       |       |
| 913745         | 10264          | 61.00        | 1 3/8"      |                | 10           | 913745T    | 15264          | 78.05        |                  |                  |                |       |       |
| 918745         | 10265          | 133.50       | 1 7/8"      |                | 12           | 1/2"       | 7/8"           | 3 1/4"       | 918745T          | 15265            | 163.25         |       |       |
| 922545         | 10266          | 161.85       | 2 1/4"      |                |              | 11/16"     | 1"             | 3 3/4"       | 922545T          | 15266            | 208.00         |       |       |
| 925045         | 10267          | 207.15       | 2 1/2"      | 3/4"           |              | 1"         | 3 3/4"         | 925045T      | 15267            | 257.00           |                |       |       |
| 901260         | 10612          | 32.00        | 1/8"        | 60°            |              | 1/16"      | 1/4"           | 2"           | 4                | 901260T          | 15612          | 36.00 |       |
| 901860         | 10614          | 32.00        | 3/16"       |                | 3/32"        | 1/4"       |                |              | 2"               | 4                | 901860T        | 15614 | 36.00 |
| 902560         | 10615          | 32.00        | 1/4"        |                | 1/8"         | 1/4"       |                |              | 2"               | 6                | 902560T        | 15615 | 36.00 |
| 903760         | 10268          | 37.35        | 3/8"        |                | 3/16"        | 3/8"       |                |              | 2 1/8"           | 8                | 903760T        | 15268 | 41.00 |
| 905060         | 10269          | 37.35        | 1/2"        |                | 7/32"        |            | 8              | 905060T      |                  | 15269            | 42.50          |       |       |
| 907560         | 10270          | 37.35        | 3/4"        |                | 5/16"        |            | 8              | 907560T      |                  | 15270            | 45.75          |       |       |
| 910060         | 10271          | 43.35        | 1"          |                | 7/16"        |            | 1/2"           | 2 1/2"       |                  | 10               | 910060T        | 15271 | 55.25 |
| 913760         | 10272          | 61.00        | 1 3/8"      |                | 9/16"        | 5/8"       | 2 7/8"         | 12           | 913760T          | 15272            | 78.05          |       |       |
| 918760         | 10273          | 133.50       | 1 7/8"      |                | 13/16"       | 7/8"       | 3 1/4"         |              | 918760T          | 15273            | 163.25         |       |       |
| 922560         | 10274          | 161.85       | 2 1/4"      |                | 1 1/16"      | 1"         | 3 3/4"         |              | 922560T          | 15274            | 208.00         |       |       |
| 925060         | 10275          | 207.15       | 2 1/2"      | 1 1/8"         | 1"           | 3 3/4"     | 925060T        |              | 15275            | 257.00           |                |       |       |

Allow one week delivery for TiN.

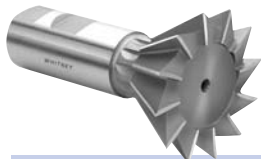

## ► M42 COBALT

- Right Hand Cut
- Single Angle
- Straight Shank

### Tolerances:

Dia. +/- .010  
Angle: +/- (1/4°)

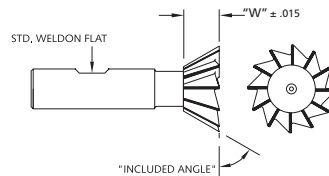

Shaded areas are NEW to this year's catalog

| M42 WTC No. | M42 EDP No. | Cutter Dia. | Included Angle | Cutter Width | Shank Dia. | Overall Length | No. of Teeth | M42 Price |       |       |
|-------------|-------------|-------------|----------------|--------------|------------|----------------|--------------|-----------|-------|-------|
| 901245M42   | 20597       | 1/8"        | 45°            | .040"        | 1/4"       | 2"             | 4            | \$36.00   |       |       |
| 901845M42   | 20599       | 3/16"       |                | 4            |            |                | 36.00        |           |       |       |
| 902545M42   | 20600       | 1/4"        |                | 6            |            |                | 36.00        |           |       |       |
| 903745M42   | 20260       | 3/8"        |                | 6            |            |                | 46.75        |           |       |       |
| 905045M42   | 20261       | 1/2"        |                | 8            | 46.75      |                |              |           |       |       |
| 907545M42   | 20262       | 3/4"        |                | 8            | 46.75      |                |              |           |       |       |
| 910045M42   | 20263       | 1"          |                | 10           | 54.10      |                |              |           |       |       |
| 913745M42   | 20264       | 1 3/8"      |                | 10           | 76.30      |                |              |           |       |       |
| 918745M42   | 20265       | 1 7/8"      |                | 12           | 1/2"       | 7/8"           | 3 1/4"       | 166.80    |       |       |
| 922545M42   | 20266       | 2 1/4"      |                |              | 11/16"     | 1"             | 3 3/4"       | 202.20    |       |       |
| 925045M42   | 20267       | 2 1/2"      | 3/4"           |              | 1"         | 3 3/4"         | 258.85       |           |       |       |
| 901260M42   | 20614       | 1/8"        | 60°            |              | 1/16"      | 1/4"           | 2"           | 4         | 36.00 |       |
| 901860M42   | 20615       | 3/16"       |                | 3/32"        | 1/4"       |                |              | 2"        | 4     | 36.00 |
| 902560M42   | 20616       | 1/4"        |                | 1/8"         | 1/4"       |                |              | 2"        | 6     | 36.00 |
| 903760M42   | 20268       | 3/8"        |                | 3/16"        | 3/8"       |                |              | 2 1/8"    | 8     | 46.75 |
| 905060M42   | 20269       | 1/2"        |                | 7/32"        |            | 8              | 46.75        |           |       |       |
| 907560M42   | 20270       | 3/4"        |                | 5/16"        |            | 8              | 46.75        |           |       |       |
| 910060M42   | 20271       | 1"          |                | 7/16"        |            | 1/2"           | 2 1/2"       |           | 10    | 54.10 |
| 913760M42   | 20272       | 1 3/8"      |                | 9/16"        | 5/8"       | 2 7/8"         | 12           | 76.30     |       |       |
| 918760M42   | 20273       | 1 7/8"      |                | 13/16"       | 7/8"       | 3 1/4"         |              | 166.80    |       |       |
| 922560M42   | 20274       | 2 1/4"      |                | 1 1/16"      | 1"         | 3 3/4"         |              | 202.20    |       |       |
| 925060M42   | 20275       | 2 1/2"      | 1 1/8"         | 1"           | 3 3/4"     | 258.85         |              |           |       |       |

ALSO AVAILABLE:  
special forms,  
profiles, left  
hand cut, Cobalt  
Super High Speed  
Steel and  
Titanium Nitride  
coating.  
Prices quoted  
on request.