

Finger Pieces

- 1) \emptyset Blank = $CD \times 1.24 = 6.82$ mm
- 2) Finished $\emptyset = CD = 5.5$ mm
- 3) \emptyset of finger holes = $CD \times 0.20 = 1.1$ mm
- 4) Holes at 38°
- 5) Radial dist. of holes = $CD \times 0.448 = 2.464$ mm
- 6) Width of finger = $CD \times 0.29 = 1.5875$ mm ($\frac{1}{6}''$)

Maltese Cross

- 1) Blank = $CD \times 1.24 = 6.82$ mm
- 2) \emptyset Concave = $CD = 5.5$ mm
- 3) Width of Slots = $CD \times 0.29 = 1.5875$ mm ($\frac{1}{6}''$)
- 4) Depth of Slots = $CD \times 0.26 = 1.43$ mm
- 5) Base diameter: $6.82 - (2 \times 1.43) = 3.96$ mm

Scale 4:1

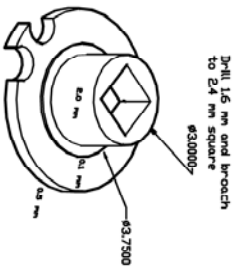
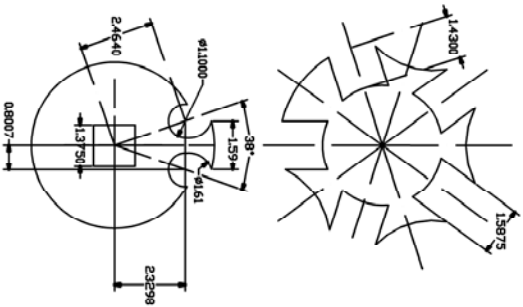
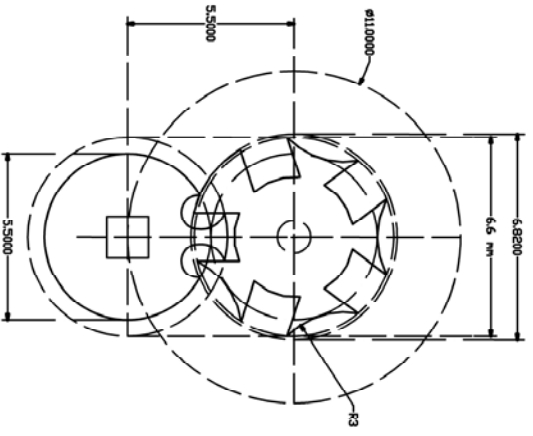

Geneva Stop Work

